

Thank you for downloading the Grid Builder Set. We hope this helps you to produce amazing layouts with your lettering and typography. We love seeing what you guys create with the products we make, so if you would like to add the hashtag #GridBuilder or #thegridslife to your posts on social media, we love to take a look and see!

Stefan & Ian

PROCREATE BRUSHES



1. One app I recommend installing on your iPad first is "FileExplorer" so that you can unzip the folder straight on your iPad.

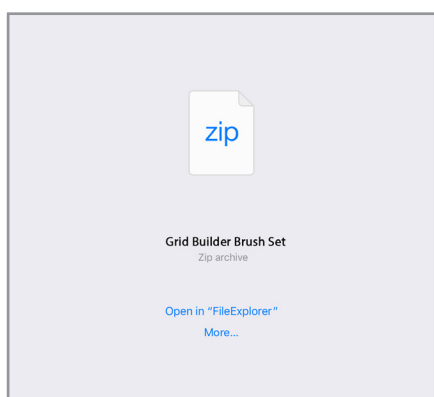

2. Once installed download the zip file via your browser and click on "Open in FileExplorer".

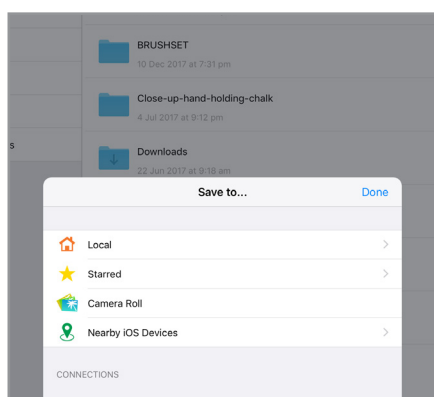

3. It will then ask you where to save it. Choose Local and click save.

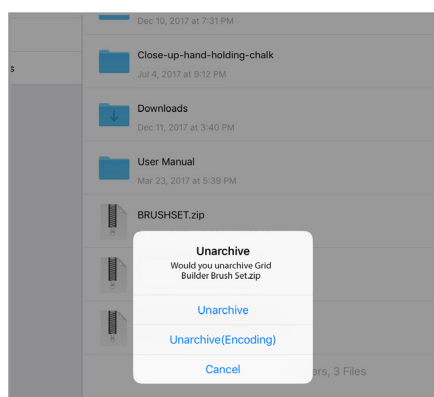

4. Click on the download zip file and it will ask you whether you want to Unarchive the zipped file. Click "Unarchive".

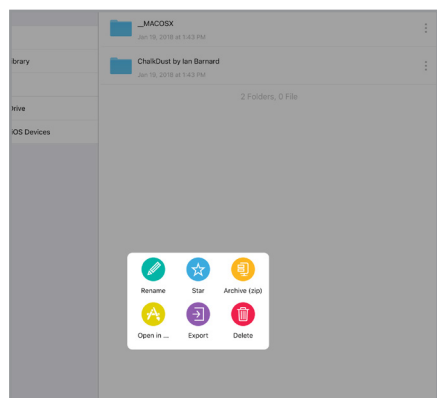

5. Click on the 3 dots to the right of the brushes folder to bring up this dialogue box. Choose "Export" and save to "On My iPad".

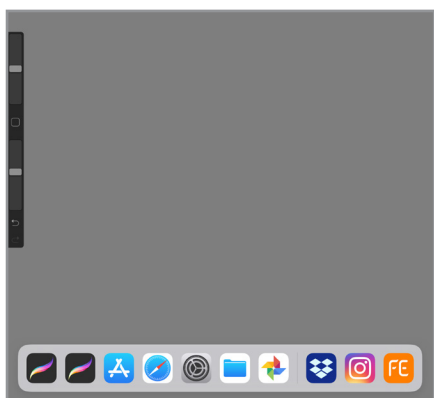

6. In Procreate swipe up from the bottom to reveal the dock.

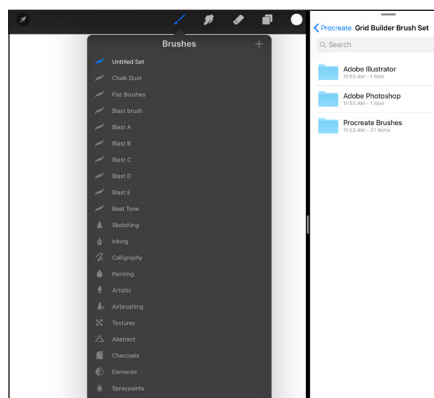

7. Drag and drop the folder icon (My Files) and let go to the right hand side of the screen so that you can see your files and Procreate in dual screen.

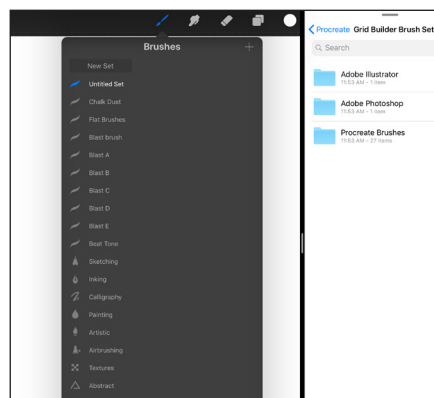

8. In Procreate click on the brushes icon and click and set up a "New Set".

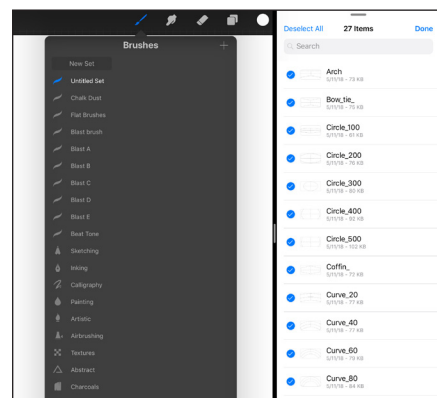

9. Locate the folder of brushes you want to import and click on "Select" (top right) and then tick the brushes you want to import so you see a blue arrow over them.



10. Drag and drop those brushes into the brush set you've created and Procreate will import all those brushes.

If you have any problems with installing the grids in any of the applications then please to reach out to us via email or on our social platforms.